

NO.	DATE	DISCRIPTION
1	1-24-97	GENERAL
2	5-23-97	PERMIT
3	8-23-96	ISSUED FOR
4	12-20-96	FOUNDATION PLAN (NORTH SIDE)

GOLDBERG DOWNEY ARCHITECTS INC.
 1178 Everett Road, Lake Forest, Illinois 60045
 (847)295-5777

THE MARCUS RESIDENCE
 CUSTOM RESIDENCE
 2225 GREENVIEW ROAD
 NORTHBROOK, ILLINOIS

A3
 SHEET 14 OF 14 SHEETS
 JOB NUMBER 95076

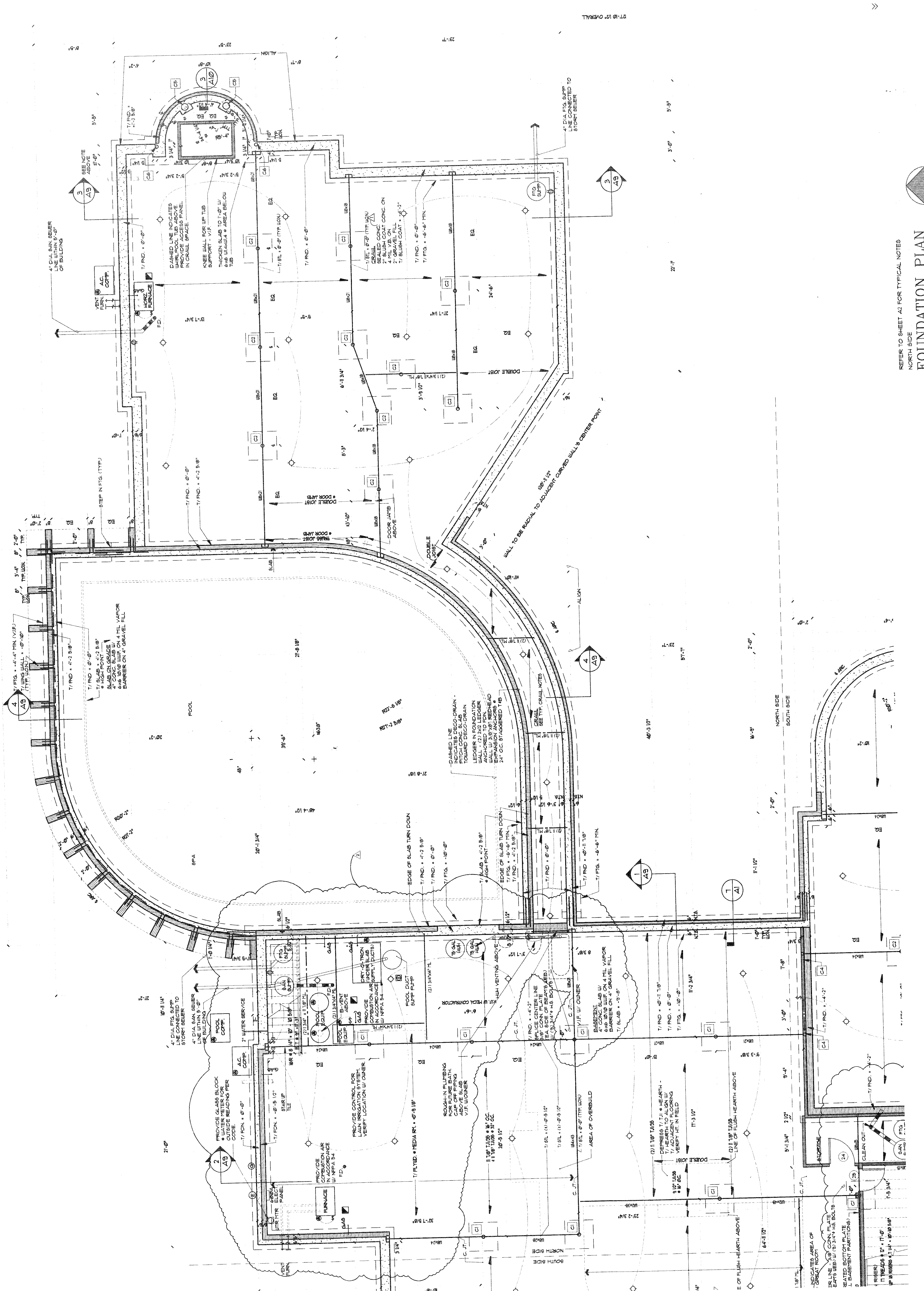

FOUNDATION PLAN
 NORTH SIDE
 REFER TO SHEET A2 FOR TYPICAL NOTES
 1/4" = 1'-0"

